



Free your Spirit

Harbour Classic

— WHITEHAVEN —

WHITEHAVEN HARBOUR CLASSIC 40

SPECIFICATIONS*

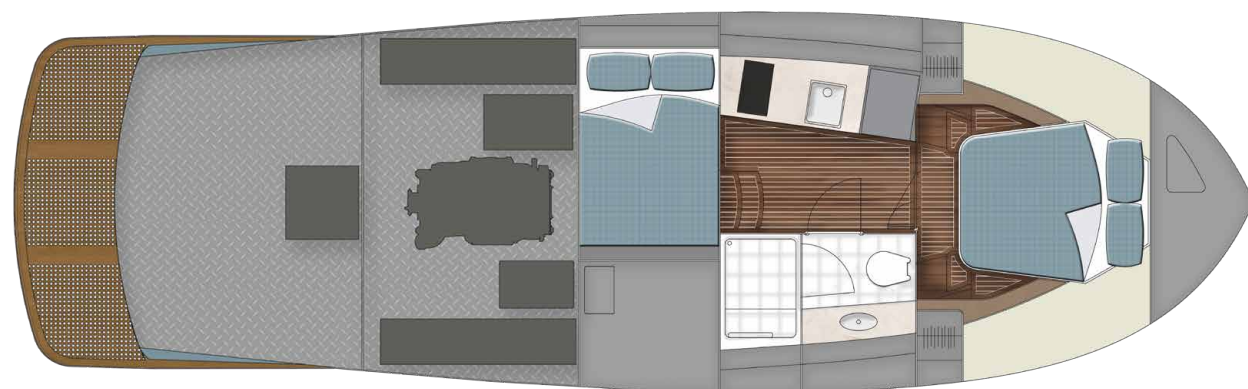

WHITEHAVEN

www.wmy.com.au

WHITEHAVEN MOTOR YACHTS
Ryan Hanson 0414 400 343
Bruce Scott 0409 655 346

QUEENSLAND
Whitehaven Motor Yachts
Jason Kowalski 0416 057 326
Peter Pembroke 0411 965 847

NEW SOUTH WALES
AWMarine Sales
Adam Workman 0419 124 939

VICTORIA
Pier 35 Boat Sales
Terry Ryan 0422 666 212

WESTERN AUSTRALIA
Martin Box Marine
Jamie Dodd 0418 819 181

WHITEHAVEN HARBOUR CLASSIC 40

SPECIFICATIONS*

Harbour Classic 40

Engine	Single Volvo D6 480hp with ZF gear box inc. electronic controls
Length Overall (inc, swim platform)	12.9m / 42' 3"
Beam (Max.)	3.9m / 12' 8"
Draft (Approx.)	0.9m / 2' 9"
Dry Weight (subject to change with engine options)	8100kgs
Sleeping Capacity (approx.)	4 persons
Fuel Capacity (approx.)	1000 litres
Water Capacity (approx.)	450 litres
Holding Tank Capacity (approx.)	151 litres



Extended Roofline Option

WHITEHAVEN

www.wmy.com.au

WHITEHAVEN MOTOR YACHTS
Ryan Hanson 0414 400 343
Bruce Scott 0409 655 346

QUEENSLAND
Whitehaven Motor Yachts
Jason Kowalski 0416 057 326
Peter Pembroke 0411 965 847

NEW SOUTH WALES
AWMarine Sales
Adam Workman 0419 124 939

VICTORIA
Pier 35 Boat Sales
Terry Ryan 0422 666 212

WESTERN AUSTRALIA
Martin Box Marine
Jamie Dodd 0418 819 181

WHITEHAVEN HARBOUR CLASSIC 40

BASE SPECIFICATIONS*

ENGINE AND GEARBOX

Single Volvo D6 480hp with ZF gear box inc. electronic controls

CONSTRUCTION

Hull moulded GRP gelcoat finish in selection of standard colours

Hull top sides core reinforced for light weight

Deckhouse moulded GRP vanilla gelcoat

Independent compartments and stringer system

Solid hull bottom with chines to waterline

Vinyl ester resin used in first outer layer of hull

Water tight collision bulkhead forward

Moulded one piece fibreglass deck and enclosed hard top

MECHANICAL & ELECTRICAL

Acoustic and thermal insulation throughout engine room

Battery paralleling system for emergency engine start

Batteries 1 x 80amp Genset Start

Batteries 2 x 200 amp House 12v power maintenance free

All AC power outlets RCD protection

All batteries fitted in battery boxes

Northern lights 4KVA Genset with muffler, water cooled

All hoses double hose clamped

Battery charger 12V for house and start bank 600amps

Bilge pump auto and manual override high water alarms x 4

Bonding system to all hull fittings, zinc anode incl. galvanic isolator

Tinned electric wiring. Where applicable coded and labelled

Trim tabs Interceptor style (Zip) with controls at helm

Ventilation system to include blowers for engine room

Bow thruster electric 12V, controls at helm

Stern thruster electric 12V, controls at helm

Engine mounts anti-vibration

Engine room lighting DC

Fire extinguishing system for engine room

Seaward 6G fresh water heater AC 60L

Fresh water pressure pump high volume 12v

Fresh water tank s/steel 450ltrs

Fuel filters (Racor) for main engine and Genset.

Fuel lines in copper or USCG all hoses

Fuel tank 1000ltrs with sight gauge & emergency cut off

Holding tank 151ltrs (approx)

Hull fittings brass fitted with ball valves

LED lighting throughout 12V

Manual hand operated bilge pump

Navigation lights LED international compliant

LED strip lighting under valances in saloon, galley & stateroom

Seawater pump for foredeck and cockpit

Seawater strainers for engines, genset

Shore power lead.

COCKPIT

Aft seating (L shaped) upholstered lounge with folding table

Refrigeration (Vitrifrigo 70ltr drawer type) to console unit

Engine room access hatch lockable

Direct and courtesy lighting

Hand held shower hot/cold

Transom door GRP, opening outwards

Swim platform teak laid inserts

Flagpole

DECK

Anchor 16kg (35lbs) stainless steel, 8mm galvanised chain by 60m

Anchor locker accessed by 2 anchor lock hatches on deck

Anchor chain safety strap

Bow roller stainless steel self loading

Bow rail 316 stainless steel flag staff at bow

Cleats stainless steel x 6, (bow x 2, spring x 2, and stern x 2)

3 x stainless steel hatches (1 x Escape) to forward deck

Fuel fillers on side decks

Fwd windscreen in safety glass bonded to FRP frame

Rub Rail stainless steel

Winch electric 12V vertical, foot switches & remote at helm

Non-slip to fwd & deck sides

Side windows tempered glass to FRP house frame

Stainless steel swim ladder

Hand rail stainless steel to roof top

Wash down tap (sea water & fresh) in anchor locker

INTERIOR

Walnut timber in satin finish

Majilite fabric finishes to contrast walls and helm

High quality Nautikflor teak and holly vinyl flooring

SALOON

Headliner in high quality upholstered vinyl

Direct, indirect and courtesy LED lighting

WHITEHAVEN

www.wmy.com.au

WHITEHAVEN MOTOR YACHTS
Ryan Hanson 0414 400 343
Bruce Scott 0409 655 346

QUEENSLAND
Whitehaven Motor Yachts
Jason Kowalski 0416 057 326
Peter Pembroke 0411 965 847

NEW SOUTH WALES
AWMarine Sales
Adam Workman 0419 124 939

VICTORIA
Pier 35 Boat Sales
Terry Ryan 0422 666 212

WESTERN AUSTRALIA
Martin Box Marine
Jamie Dodd 0418 819 181

HARBOUR CLASSIC 40

BASE SPECIFICATIONS*

Tinted glass for saloon windows

U-Shaped dinette with timber table

Wabasto hatch to roof (Manual opening)

Fully enclosed glass bulkhead with s/steel frame inc. lockable door & hopper window

TV to saloon (drop down starboard side opposite dinette)

Fusion sound system Bluetooth connectivity with, speakers to salon and cockpit

Double GPO (pop up)

HELM

Double helm seat (cozy) with footrests

Opening starboard side window adjacent helm seat

Raised dash pod for navigation equipment

Electronic engine/s controls

Bow and stern thruster controls

Windscreen wipers x 3 and washers

Trim tab controls and indicator

Horn and wiper switches

Navigation and anchor light switches

Fuel and water gauges

Compass

VHF radio

Drink holder

GALLEY

Storage lockers

Bench-top with storage cabinets & draws below bench

Single lever mixer tap to galley sink

Refrigerator with freezer (DC)

Microwave

Hatch stainless steel to roof

2 burner AC cooktop

Dishwasher

Double GPO

STATEROOM FORWARD

Hanging locker stbd /port cedar lined with auto lighting DC

Hatch stainless steel (escape) to roof

Head board upholstered

Storage cabinet underneath berth incl. Draw units & gas strut for easy access

Open bed (double)

Mattress drawers and storage

Reading lights

Double GPO

DAY HEAD / BATHROOM

Bench-top including basin and mixer tap

Entrance door

Lighting overhead vanity DC

Wall mirror

Extraction fan

Shower with glass door

Shower head handheld

Toilet roll holder

Towel rail

Under bench vanity draw and shelf storage

Jabsco macerator toilet

Vanity cabinet above sink

Hatch Stainless Steel to roof

Double GPO

DAY/NIGHT BED

Midship open bed (double)

Mattress

Headboard upholstered

Reading lights

Storage locker outboard

GENERAL

Soft furnishings package

Antifouling 2 x coats epoxy undercoat and 2 x coats antifoul

External block out covers to windscreens and saloon side windows

Fenders x 3

Docking lines x 3

AT WHITEHAVEN, WE PROUDLY STAND BEHIND THE FINISH AND PERFORMANCE OF OUR VESSELS. FOR YOUR PEACE OF MIND, WE OFFER AN EXCEPTIONAL 5 YEAR HULL AND STRUCTURAL AND 3 YEAR WHITEHAVEN MANUFACTURED ITEM WARRANTY.

WHITEHAVEN

www.wmy.com.au

WHITEHAVEN MOTOR YACHTS
Ryan Hanson 0414 400 343
Bruce Scott 0409 655 346

QUEENSLAND
Whitehaven Motor Yachts
Jason Kowalski 0416 057 326
Peter Pembroke 0411 965 847

NEW SOUTH WALES
AWMarine Sales
Adam Workman 0419 124 939

VICTORIA
Pier 35 Boat Sales
Terry Ryan 0422 666 212

WESTERN AUSTRALIA
Martin Box Marine
Jamie Dodd 0418 819 181

WHITEHAVEN HARBOUR CLASSIC 40

2019 PRICING*

OPTIONS AVAILABLE

ENGINES AND GEARBOXES

- Single Diesel - Cummins QSB 6.7 550hp with ZF gearbox inc electronic engine controls
- Twin Diesel - 2 Volvo IPS D6 400 221.0kW 301hp each with electronic engine controls to inc volvo autopilot and joystick controls

MECHANICAL AND ELECTRICAL

- Seakeeper 3 Stabiliser (operates on DC power)
- Twindisc Express Joystic System (EJS) to include Quickshift Transmission, EC300 single lever station, 2 x Joystick stations with upgraded bow/stern thrusters to Hydraulic.
- Express Positioning System EPS (only available with EJS upgrade)
- Proportional Control Side Power bow and stern thrusters DC.
- C-Zone fitted to 12V DC electrical system
- Upgrade to Onan generator with auto start / stop function
- Inverter 3KVA package and upgraded battery bank
- Search light
- Underwater lights x 2 fitted to transom (Lumitec Seablaze 3)
- Anchor Chain Counter
- Stainless steel skin fitting upgrade
- Toilet upgrade to vacuum flush

DECKHOUSE

- Extended hardtop roof to cover aft cockpit seating with feature stainless steel support posts
- Sureshade electric retractable awing fitted (available with std roof only)

FOWARD DECK AND SIDE DECKS

- Upgraded bow rail to oval stainless steel style.
- Stainless steel chafe plates fitted to all cleat locations
- Teak laid (or synthetic fitted) to forward and side decks

COCKPIT

- Additional joystick control
- Additional Vitrofrigo drawer type fridge or freezer (inc ice maker) x 70 ltr to console
- Teak laid to cockpit

- Upgrade cockpit table to teak laid finishes and slide mechanism hi/low to coffee table in lieu of folding top
- Upgrade cockpit seating to premium Silvertex vinyl outdoor fabrics with stitched strap detail

SALOON

- Air conditioning 12,000 BTU with additional outlets to helm
- Upgrade to premium Italian leather with diamond stitched finishes to helm seat, backrest carcass and dinette.
- Webasto roof hatch to electric operation
- Upgrade to electric raise / lower helm side window.
- Vitrofrigo ice maker fitted below helm seat
- Timber upgrade (eg limed walnut/ash)
- Upgrade dash (carbon feature switch strip, lower face in premium leather, main dash POD panel in hull colour)

GALLEY / LOWER ACCOMMODATION

- Air conditioning to lower accommodation 12,000 BTU
- Upgrade to premium Italian leather and diamond stitched bed heads
- Upgrade from Staron to Corian bench tops
- Upgrade to premium galley tapware

HULL COLOUR

- Painted hull topsides lower deckhouse
- Painted toe rails

EXTERIOR CANVAS / COVERS

- Cockpit storm cover (inc zipper access at transom door - long roof option only)
- External breezeway covers to windscreens and saloon side windows
- Infills to cockpit qtr panel in Plexi-glass

SWIM PLATFORM

- Stainless Steel rails
- BBQ sas to include stainless steel bottle (removable)

NAVIGATION PACKAGE

- Garmin 7412xsv 12" multi-function display
- Garmin N2k starter kit
- Garmin G2 Vision chart card
- Garmin Autopilot (standard with IPS)

WHITEHAVEN

www.wmy.com.au

WHITEHAVEN MOTOR YACHTS
Ryan Hanson 0414 400 343
Bruce Scott 0409 655 346

QUEENSLAND
Whitehaven Motor Yachts
Jason Kowalski 0416 057 326
Peter Pembroke 0411 965 847

NEW SOUTH WALES
AWMarine Sales
Adam Workman 0419 124 939

VICTORIA
Pier 35 Boat Sales
Terry Ryan 0422 666 212

WESTERN AUSTRALIA
Martin Box Marine
Jamie Dodd 0418 819 181